

GOOD FOR CONSTRUCTION

BAR NO.	BAR DIA. (mm)	SPACING (mm)	SHAPE
1	16	200 c/c	
2	16	200 c/c	
3	16	200 c/c	
4	16	200 c/c	
5	10	150 c/c	
6	10	150 c/c	
7	10	150 c/c	
8	12	150 c/c	
9	10	150 c/c	
10	10	150 c/c	
11	10	150 c/c	
12	12	200 c/c	
13	12	200 c/c	
14	12	200 c/c	
15	10	3 Nos	
16	10	2 Nos	

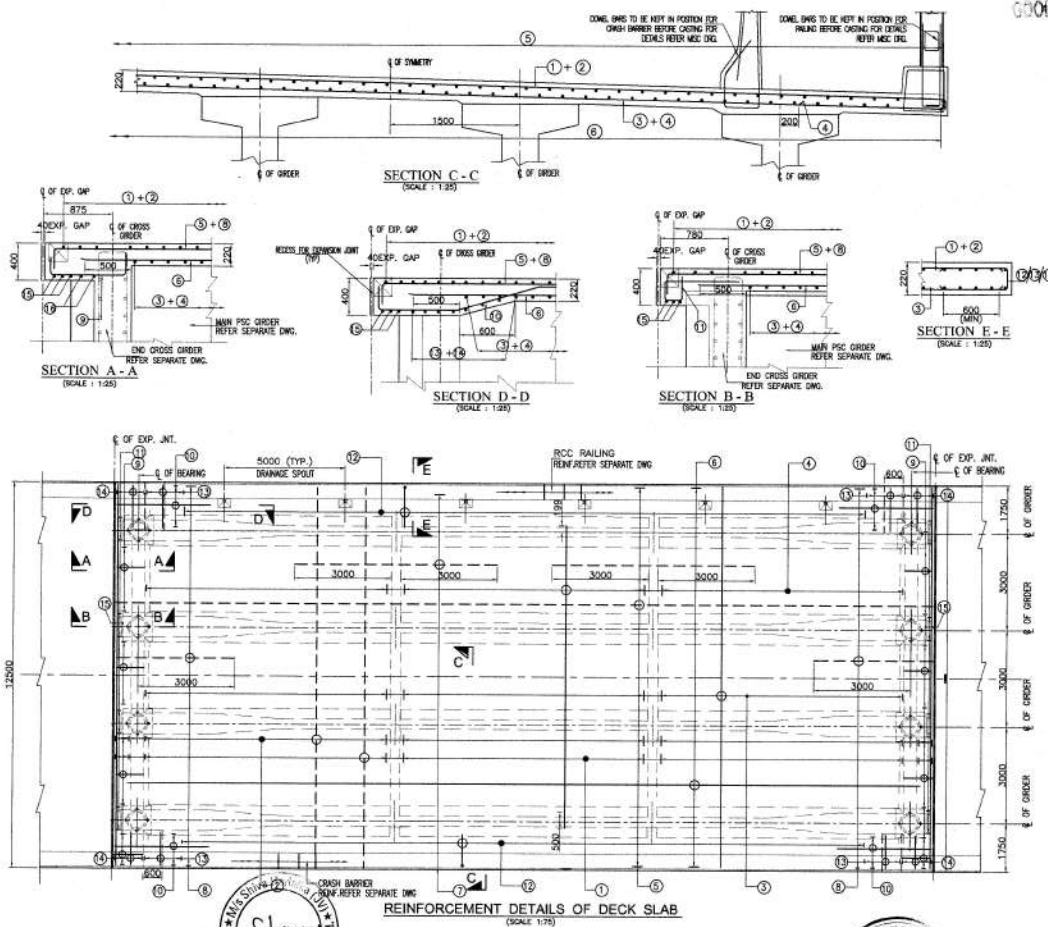

- NOTES:**
- ALL DIMENSIONS ARE IN MILLIMETRES, UNLESS OTHERWISE SPECIFIED.
 - GRADE OF CONCRETE FOR DECK SLAB - M40 OR GRADE OF STEEL - F450
 - CONSIDERING 50% LAP, MINIMUM LAP LENGTH SHALL BE 34d, WHERE d IS SMALLER DIAMETER OF BAR. AS PER IRC112-2020.
 - SPACING OF BARS SHALL BE DONE.
 - MINIMUM ANCHORAGE LENGTH SHALL BE 36d WHERE d IS DIA. OF BAR.
 - FOR LOCATION OF DRAINAGE SPOUT, REFER SEPARATE DRAWING.
 - FOR REINFORCEMENT DETAIL OF CRASH BARRIER, REFER SEPARATE DRAWING.

LEGEND:

— TOP REINFORCEMENT

— BOTTOM REINFORCEMENT

LV — LENGTH VARIES

Signature
Bridge Engineer
VSPL, Sivasagar

PROJECT: FOR PLANNING OF BRIDGE TO CROSS SECTION FROM 40+00 TO 40+200 ON JALPAIGURI ROAD, DISTRICT: JALPAIGURI, WEST BENGAL.	DRAWN BY: SKM	CHECKED BY: SKM	SCALE: AS SHOWN	DATE: MAR. 2023
APPROVED BY: SKM	PROJECT NO.: VSPL/2023/001	SHEET NO.: 01 OF 01	PREPARED: SKM	DESIGNED: SKM
CHECKED: SKM	APPROVED: SKM	DATE: MAR. 2023	TITLE: REINFORCEMENT DETAILS OF RCC DECK	REVISION: 01